

How to find us

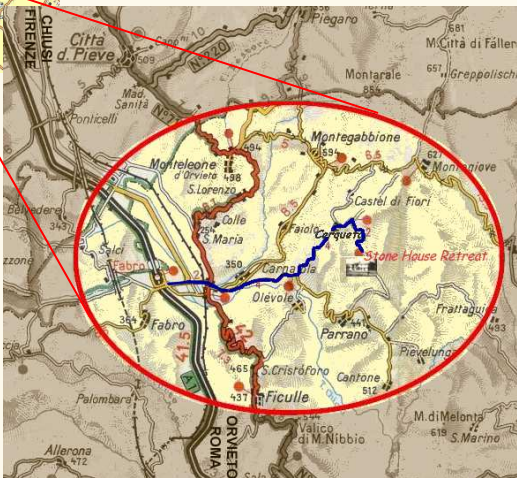

Your country house in Umbria

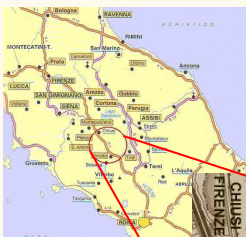

Day trips

- | | |
|-----------------------|------------------------------|
| Orvieto (35 Km) | Città della Pieve (25 Km) |
| Assisi (65Km) | Perugia (50 Km) |
| Montepulciano (45 Km) | Pienza (50 Km) |
| Bagno Vignoni (65 Km) | Chiusi (30 Km) |
| San Casciano (30 Km) | Todi (50 Km) |
| Arezzo (85 Km) | Siena (95 Km) |
| S.Antimo (85 Km) | Cortona (65 Km) |
| Spello (68 Km) | Deruta (58 Km) |
| Florence (120 Km) | Civita di Bagnoregio (55 Km) |
| Rome (130 Km) | La Scarzuola (7 Km) |

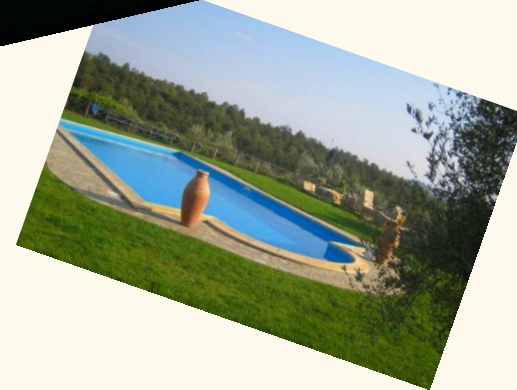
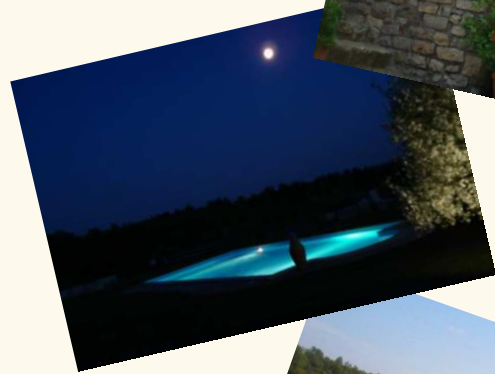

Address: Contrada Bagno Località Manziano 16
05010 PARRANO (TR) - ITALY

Web site: www.stonehouseretreat.com
E-Mail: info@stonehouseretreat.com

Tel.: +39 0763 838084
Mobile: +39 333 6003109

Relais Antiche Pietre is our country house situated overlooking the beautiful valley of "Bagno" and the medieval village of Parrano in **Umbria**, with our closest neighbour being the famous **Tuscany**.
Sitting on three hectares of natural grassland, incorporating an olive grove and fruit trees, it is surrounded by unspoiled woodland with spectacular views towards the picturesque castle of Parrano (dating back around 1000 years).
Positioned perfectly for the must-see destinations of **Rome** and **Florence**, we are situated within 10km of major motorways and train stations, however still maintaining the seclusion and tranquility of a **totally rural environment**. Within less than a 70 km radius, we have such impressive cities as Siena, Perugia, Assisi, Arezzo, Orvieto, Cetona, Montepulciano, Todi, and Spoleto, just to name a few.





"Lavanda" being the largest has views of the gardens and of the valley to the south and west.



"Girasole" is located in the oldest part of the house and boasts views of the gardens to the east and also fantastic sunsets to the west.



"Papavero" is an independent studio with views of the valley to the south and a spectacular outlook to the pool.

The apartments

For our guests we have three independent suites; each containing a double bedroom of generous proportion, private bathroom, kitchenette, dining and sitting areas with double sofa beds in two of these apartments.

Outside, each suite enjoys private access via its own alfresco dining area.

For the colder months, each suite is centrally heated.

You may prefer to stay in the "Lavanda" (Lavender) suite (50 sqm), or in the "Girasole" (Sunflower) suite (45 sqm), or in the "Papavero" (Poppy) studio (40 sqm) tastefully decorated in gentle tones of the corresponding flowers that have become synonymous with this area through spring and summer.

With the gardens now established and pool area completed our guests can enjoy secluded spots located around the property.

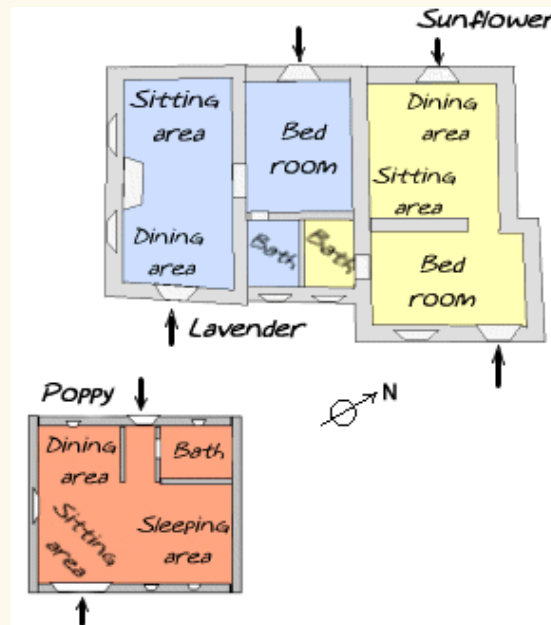

Tariffs

Prices are for double occupancy for a minimum of 3 nights.

Extra person supplement 25%.

Only adults (our property is not child friendly) and please no pets.

Check-in time after 3 p.m. / Check-out time midday.

For listings of current prices and other relevant information please consult our website at www.stonehouseretreat.com

Facilities included:

Complimentary tea, coffee, espresso, and other essential condiments. Bottle of wine on arrival, breakfast basket for first morning. Pool towels, linen, warm water and fan. Wireless Internet connection 24 hours. Self-service washing machine.

Not included:

For stays in excess of 1 week an extra charge of € 20,00 for linen change and cleaning.

For other services such as personal laundry, shopping services, daily house-keeping or transportation services extra charges apply accordingly.

NB: prices and conditions are subject to change without notice.

